

Stevens County Title Company

280 S Oak - 100 E Birch, Colville, WA 99114
(Ph) 509-684-4589 - (Fx) 509-684-5448

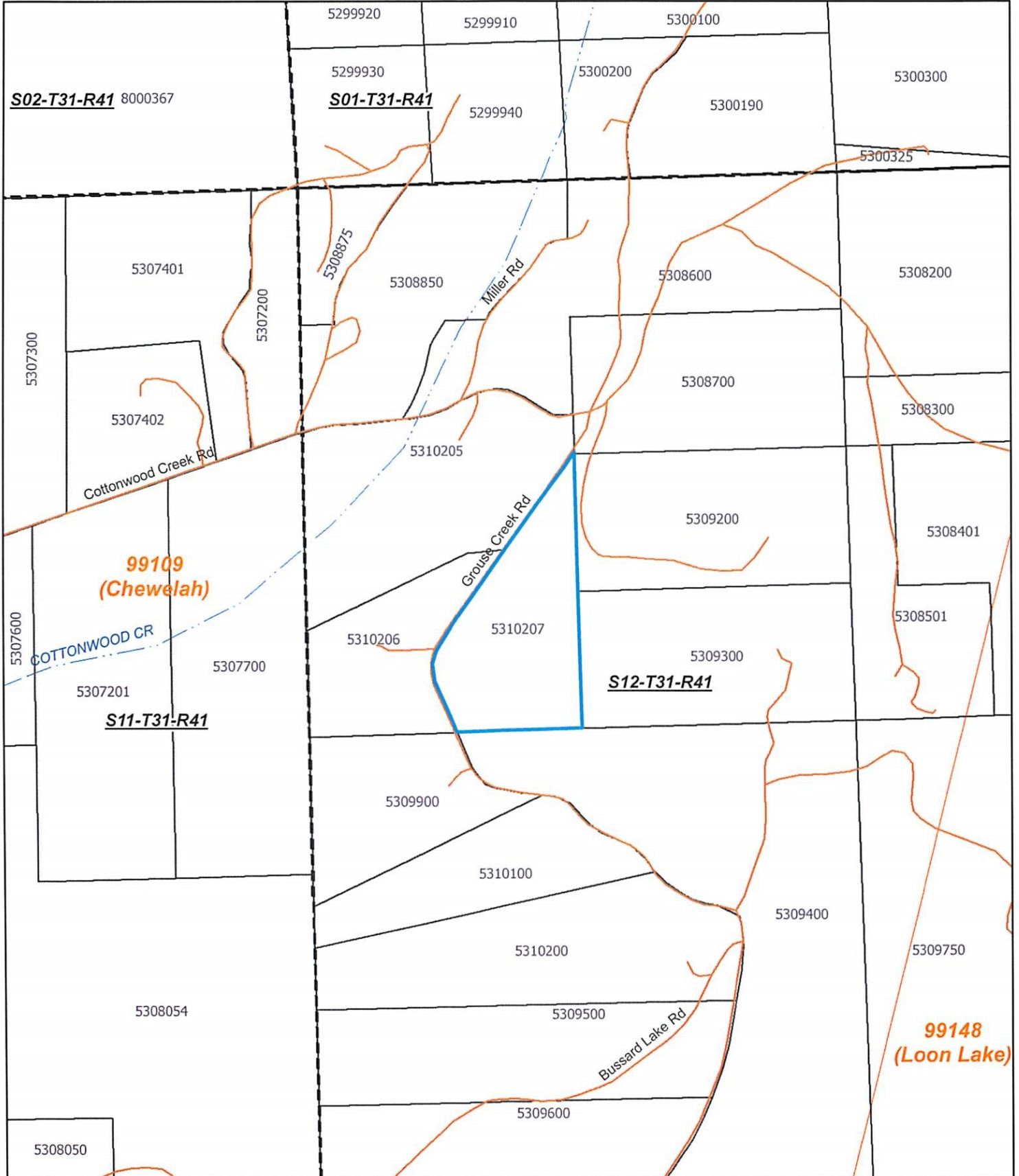

0 225 450 900 1,350 1,800 Feet

1 inch = 600 feet



This sketch is furnished for your information only. The Company has not surveyed the premises and assumes no liability for any inaccuracy therein.

EXHIBIT A

Parcel: 5310207

That part of the SW1/4 of the NW1/4 and that part of the S1/2 of the NW1/4 of the NW1/4, all in Section 12, Township 31 North, Range 41 East, W.M., in Stevens County, Washington, lying Easterly of the centerline of Bussard Extension County Road No. 1959.

END OF EXHIBIT A

Seller's Initials _____

File No. 134644, Manton

Buyer's Initials _____